



**Geweke Asset Management**

**248 E. Kettleman Lane • Lodi, CA**

**N O W  
LEASING**

For information, contact:

**GEWEKE ASSET  
MANAGEMENT  
(209) 333-4565**

1139 E. Kettleman Lane  
Suite 200  
Lodi, CA 95240  
Fax: (209) 334-1829

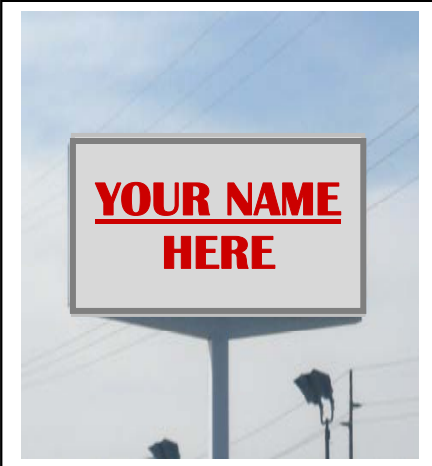

**YOUR NAME  
HERE**

Land Square Footage  
2.55 acres  
111,078+ sq.ft.

Building Square Footage  
21,040+ sq.ft.

**CALL NOW FOR DETAILS  
(209) 333-4565**

**248 E. Kettleman Lane • Lodi, CA**

**N O W  
LEASING**



For Further Information,  
Contact:

**GEWEKE ASSET  
MANAGEMENT**  
(209) 333-4565

1139 E. Kettleman Lane  
Suite 200  
Lodi, CA 95240

### PROPERTY INFORMATION:

This rare opportunity features a 2.55 acre, that's over 111,078 sq.ft. of land! Situated close to many local businesses, a public school, local residence and convenient access to Highway 99 for visitors and guests of neighboring cities. This location features a large lot with ample parking; many office spaces with a private upstairs conference room and an abundance of storage spaces. Many potentials for a recreational or fitness center. Well equipped for any dealership with repair service. This location is a great opportunity for any new or existing business. Please contact *Geweke Asset Management* for more information.

### FEATURES

- Address:
  - 248 E. Kettleman Lane (APN: 062-060-046)
- Available Space:
  - ± 2.55 acres (Land)
  - ± 21,040 sq.ft. (Building) - Approx. 80ft Deep x 263ft Wide
- Equipped with Dump Station
- Monument Signage Available

### DEMOGRAPHICS (2008):

#### Population

1-mile	21,904
3-mile	65,711
5-mile	79,394

#### Average HH Income

1-mile	52,737
3-mile	61,811
5-mile	65,807

#### Median HH Income

1-mile	41,942
3-mile	48,030
5-mile	50,123

### TRAFFIC COUNTS (2008):

Kettleman Road	26,500 ADT
Highway 99	68,000 ADT

© 2009 Geweke Asset Management | The information above has been obtained from sources believed reliable. While we do not doubt its accuracy, we have not verified it and make no guarantee, warranty or representation about it. It is your responsibility to independently confirm its accuracy and completeness. Any projections, opinions, assumptions or estimates used are for example only and do not represent the current or future performance of the property. The value of this transaction to you depends on tax and other factors which should be evaluated by your tax, financial and legal advisors. You and your advisors should conduct a careful, independent investigation of the property to determine to your satisfaction the suitability of the property for your needs.



**Geweke Asset Management**

248 E. Kettleman Lane • Lodi, CA



For Further Information,  
Contact:

GEWEKE ASSET  
MANAGEMENT  
(209) 333-4565

1139 E. Kettleman Lane  
Suite 200  
Lodi, CA 95240



Large Shop with Six Roll-Up Doors

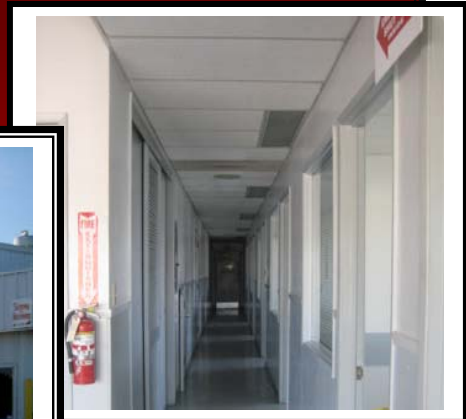
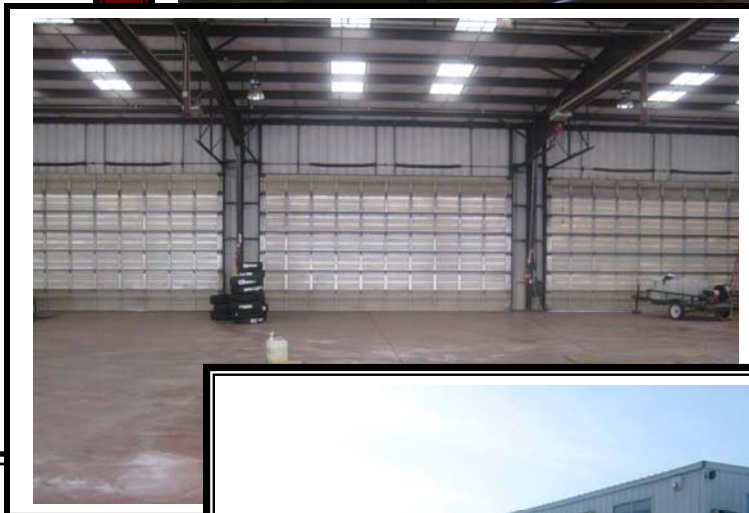

Plenty Office Space

**PROPERTY  
PHOTOS**



# Geweke Asset Management

## 248 E. Kettleman Lane

### Lodi, CA 95240

For Further Information,  
Contact:

GEWEKE ASSET  
MANAGEMENT  
(209) 333-4565

1139 E. Kettleman Lane  
Suite 200  
Lodi, CA 95240

**AERIAL MAP  
NEIGHBORING  
BUSINESSES**





For Further Information,  
Contact:

GEWEKE ASSET  
MANAGEMENT  
(209) 333-4565

1139 E. Kettleman Lane  
Suite 200  
Lodi, CA 95240

### Bldg. Layout Parcel Map

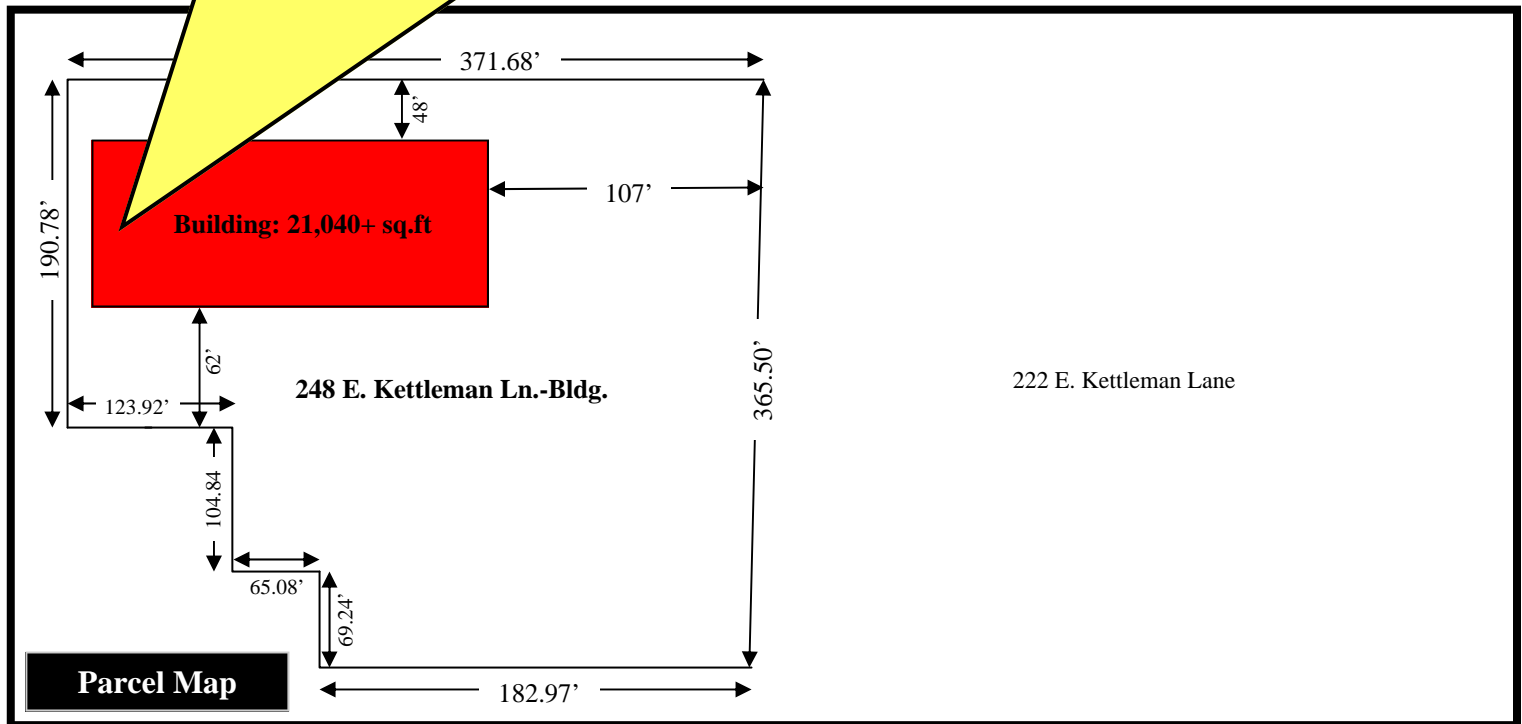
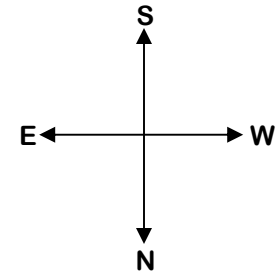
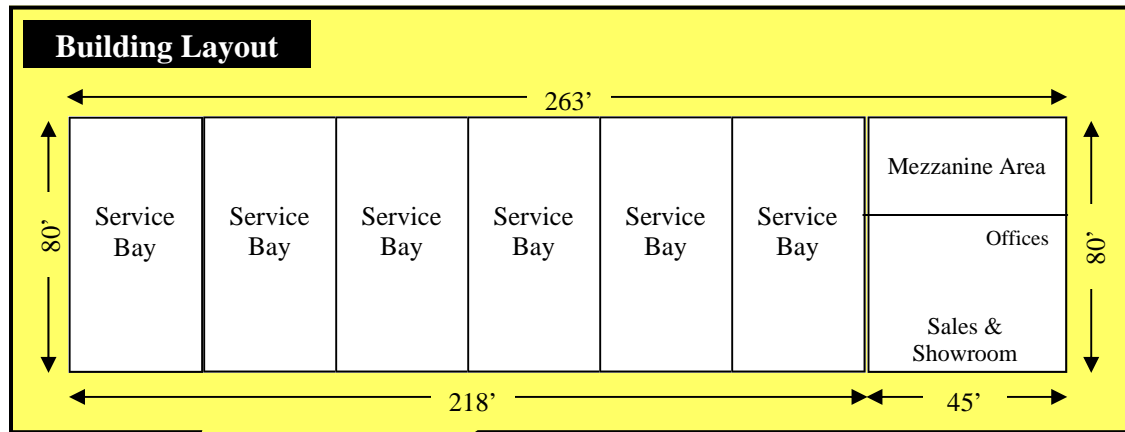

## KETTLEMAN LANE